

Chain Block

OPERATORS MANUAL

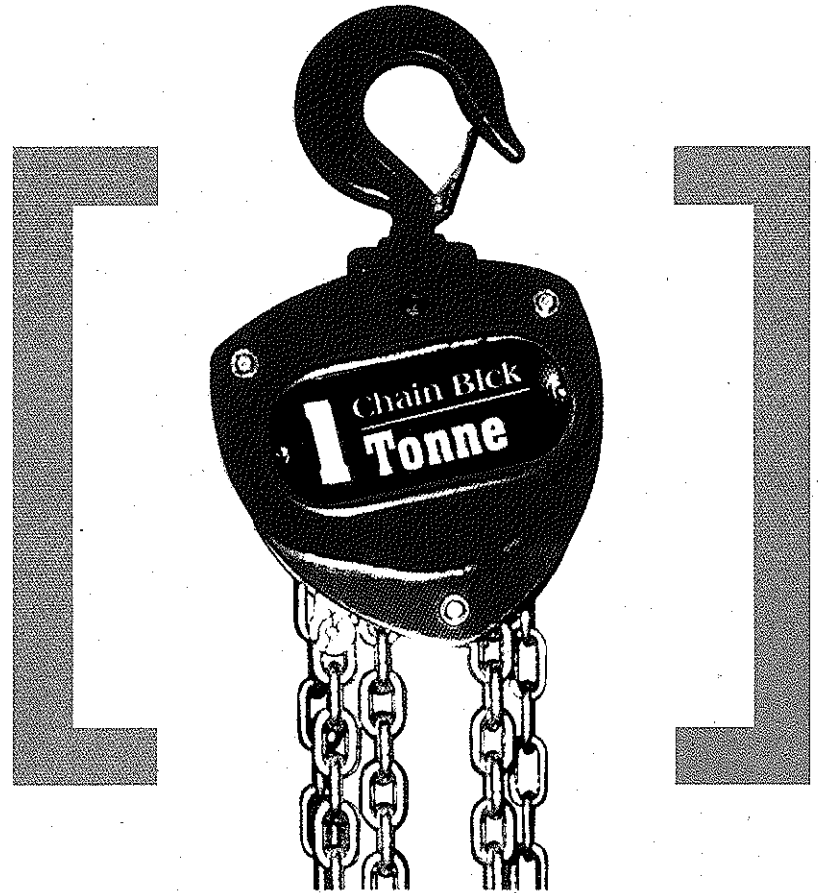

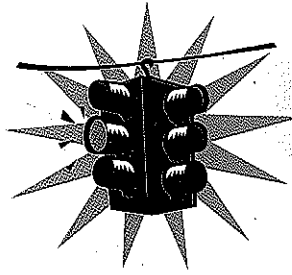

WARNING!

Ensure that you have read the operating instructions fully and understand them prior to using the chain block.

- Never shock load the chain block.
- The chain block should be visually inspected for damage or faults prior to use.
- Never exceed the rated capacity of the chain block.
- Do not use the load chain as a sling. This will damage the load chain.
- Do not use more than one chain block to lift or move a load.
- Do not use the chain block if the chain is twisted, kinked or damaged.
- Do not operate the chain block unless the load is centred between the top and bottom hooks.
- Never use the chain block if either hook is stretched, deformed, damaged or has a broken or missing safety catch.
- Only qualified personnel should operate chain blocks.
- Do not use the chain block to lift people or loads over people.

PARTS LIST

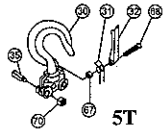

30	Top Hook Assy.	67	Lock Nut
31	Double Spring	68	Screw
32	Safety Latch	70	Lock Nut
35	Top Hook Pin		

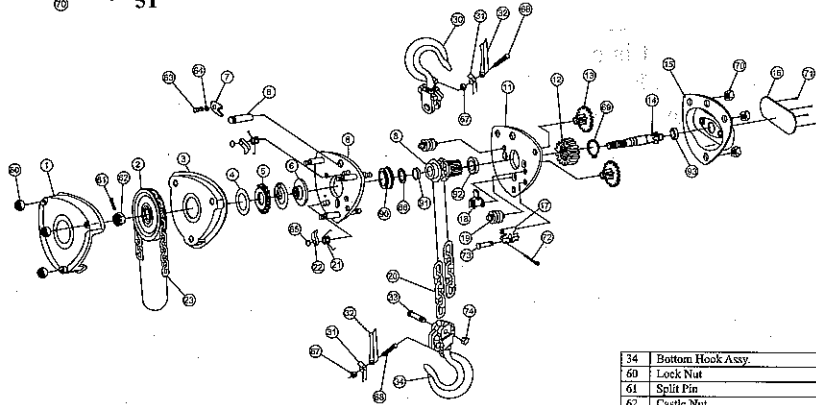

1	Hand Wheel Cover	8	Hook Connector	21	Pawl Spring	34	Bottom Hook Assy.
2	Hand Chain Wheel	9	Left Side Plate Assy.	22	Pawl	60	Lock Nut
3	Protective Cover	10	Load Chain Sprocket	23	Hand Chain	61	Split Pin
4	Friction Plate	11	Right Side Plate Assy.	30	Top Hook Assy.	62	Castle Nut
5	Ratchet Disc	12	Split Gear	31	Double Spring	63	Screw
6	Brake Seat	13	Disk Gear Assy.	32	Safety Latch	64	Spring Washer
7	Positioning Plate	14	Shaft	33	Suspension Pin	65	Snap Ring
						66	Snap Ring
						67	Lock Nut
						68	Screw
						69	Snap Ring
						70	Lock Nut
						71	Name Plate Rivet
						72	Split Pin
						73	Pin Shaft
						74	Lock Nut
						90	Left Bearing
						91	Needle Bearing
						92	Right Bearing
						93	Bearing

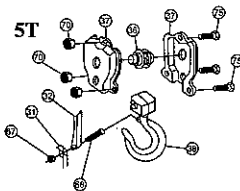

31	Double Spring	67	Lock Nut
32	Safety Latch	68	Screw
36	Idle Sheave Assy.	70	Lock Nut
37	Bottom Hook Assy.	75	Pin
38	Bottom Hook Assy.		

MAINTENANCE

- 1: After use clean any dirt or water off the unit and lubricate the load chain and swivel hook.
- 2: Maintenance and inspection should only be carried out by qualified personnel
- 3: After repairs or maintenance the chain block should be tested to ensure that it is operating correctly.
- 4: If the chain block is used outdoors additional care should be taken regarding maintenance.

INSPECTION

- 1: The chain block should be inspected prior to use for any damage or faults. Also listen for unusual sounds which may indicate trouble.
- 2: Brakes require more than audio-visual inspection. Check frequently by operating the chain block with and without a load, stopping at various positions to test that the load is being held correctly. If the load moves or slips the chain block should be taken out of service and repaired.



Never exceed the rated capacity of the chain block.



Do not operate the block if the chain is kinked, damaged or twisted.

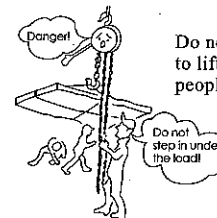

Do not use the chain block to lift people or loads over people.



If you are unable to move the hand chain, stop immediately and inspect the chain block for damage

CHAIN AND HOOKS

The hooks and load chains are made of special alloy-steels and are precisely heat-treated. Never weld or heat-treat them again.

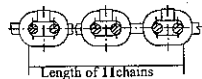

CHAIN DIMENSIONS

Capacity (Tons)	Diameter of Chain Wire	Maximum Allowable Gauge Length (11 links)
0.5	Ø 5.0mm	169.95mm
1	Ø 6.3mm	215.27mm
2	Ø 8.0mm	271.92mm
1.6 3	Ø 7.1mm	237.93mm
5 10	Ø 9.0mm	305.91mm

(a) Load Chain

The load chains are exceptionally long-wearing, but wear is unavoidable and certain conditions will cause wear and corrosion that will lessen the strength. Load chains worn beyond the permissible limits shown in the Table 1 must be replaced at once.



HOOK THROAT OPENING

Capacity (Tons)	Hook Throat Opening	
	New Hook O Equals	Replace When O Equals
0.5	23.6mm	25.96mm
1	28.0mm	30.80mm
1.6	31.5mm	34.65mm
2	33.5mm	36.85mm
3	37.5mm	41.25mm
5	42.5mm	46.75mm
10	60.0mm	66.00mm

(b) Hooks

The hook opening will elongate with overloads and incorrect hooking. When the hook opening is elongated beyond the permissible limits shown in the Table 2, it is dangerously deformed and must be replaced immediately.

ALIGNMENT OF GEARS DURING REASSEMBLY

All Capacities

Align teeth between two marks at the gear spline on horizontal centerline, one facing toward centre and one facing outward, as shown. (Inner/Outer relation)

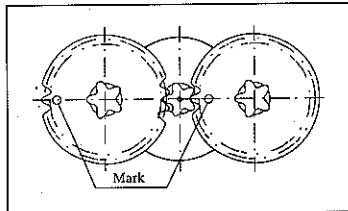

Inspection Certificate

It is hereby certified that this product was manufactured under our singleunit quality control system and has passed strict inspection in accordance with our inspection standards.

COMMODITY MODEL NUMBER	CHAIN BLOCK HSZ
DATE	JAN. 30, 2015
CAPACITY	2.0 ton
TEST LOAD	3.0 ton
LIFT	3.0 m
TYPE OF LOAD CHAIN	GRADE - DIAMETER T - 8 mm

CHIEF INSPECTOR

02

LIMITED WARRANTY

Vestil Manufacturing Corporation (“Vestil”) warrants this product to be free of defects in material and workmanship during the warranty period. *Our warranty obligation is to provide a replacement for a defective original part if the part is covered by the warranty, after we receive a proper request from the warrantee (you) for warranty service.*

Who may request service?

Only a warrantee may request service. *You are a warrantee if you purchased the product from Vestil or from an authorized distributor AND Vestil has been fully paid.*

What is an “original part”?

An original part is a part used to make the product as shipped to the warrantee.

What is a “proper request”?

A request for warranty service is proper if Vestil receives: 1) a photocopy of the Customer Invoice that displays the shipping date; AND 2) a written request for warranty service including your name and phone number. Send requests by any of the following methods:

Mail
Vestil Manufacturing Corporation
2999 North Wayne Street, PO Box 507
Angola, IN 46703

Fax
(260) 665-1339
Phone
(260) 665-7586

Email
sales@vestil.com

In the written request, list the parts believed to be defective and include the address where replacements should be delivered.

What is covered under the warranty?

After Vestil receives your request for warranty service, an authorized representative will contact you to determine whether your claim is covered by the warranty. Before providing warranty service, Vestil may require you to send the entire product, or just the defective part or parts, to its facility in Angola, IN. The warranty covers defects in the following *original* dynamic components: motors, hydraulic pumps, electronic controllers, switches and cylinders. It also covers defects in *original* parts that wear under normal usage conditions (“wearing parts”): bearings, hoses, wheels, seals, brushes, batteries, and the battery charger.

How long is the warranty period?

The warranty period for original components is 1 year. The warranty period begins on the date when Vestil ships the product to the warrantee. If the product was purchased from an authorized distributor, the period begins when the distributor ships the product. Vestil may extend the warranty period for products shipped from authorized distributors by *up to 30 days* to account for shipping time.

If a defective part is covered by the warranty, what will Vestil do to correct the problem?

Vestil will provide an appropriate replacement for any *covered* part. An authorized representative of Vestil will contact you to discuss your claim.

What is not covered by the warranty?

1. Labor;
2. Freight;
3. Occurrence of any of the following, which automatically voids the warranty:
 - Product misuse;
 - Negligent operation or repair;
 - Corrosion or use in corrosive environments;
 - Inadequate or improper maintenance;
 - Damage sustained during shipping;
 - Collisions or other incidental contacts causing damage to the product;
 - Unauthorized modifications: DO NOT modify the product IN ANY WAY without first receiving written authorization from Vestil. Modification(s) might make the product unsafe to use or might cause excessive and/or abnormal wear.

Do any other warranties apply to the product?

Vestil Manufacturing Corp. makes no other express warranties. All implied warranties are disclaimed to the extent allowed by law. Any implied warranty not disclaimed is limited in scope to the terms of this Limited Warranty.

